



PERMIT TO CONSTRUCT
Onsite Wastewater System

File Nbr: **2019090034**
County: **Saluda**

Name: AMERICAN LAND HOLDINGS LLC

Program Code: 362

Type Facility: HOUSE

Address: 59 MIDDLETON DR
LUGOFF, SC 29078

System Code: 271

Subdivision: PALMETTO POINTE

Site: LOT 94

TM#:

Block: Lot: 94

, SC

Water Supply: PUBLIC

PERMIT TO CONSTRUCT SYSTEM SPECIFICATIONS

Daily Flow (gpd): 360

Tank Sizes (gal): Septic Tank: 1000 Pump Chamber: 1000

Grease Trap:

LTAR: .25

Trenches: Length (ft): 509 Width (in): 48 Max. Depth (in): 22

Agg. Depth (in): 9

Min Pump Capacity: 10 gpm at 20

ft. of Head

SPECIAL INSTRUCTIONS/CONDITIONS

THIS PERMIT IS SITE SPECIFIC ANY CHANGES TO THE SYSTEM MUST BE APPROVED BY DHEC. ALTERNATIVE TRENCH PRODUCTS APPROVED UNDER STATE RULES AND REGULATIONS MAY BE SUBSTITUTED. ANY UNAPPROVED CHANGES WILL VOID THIS PERMIT

See Attached Page...

PERMIT TO CONSTRUCT SYSTEM DIAGRAM

(NTS)

System design by
Land Resource Management soil
classifier Walker Ferguson
828-231-1663
see Attached supplemental
diagram

Issued/Revised By:

Date:

11/15/19



APPLICATION SUPPLEMENTAL FORM

File Nbr: **2019090034**

Onsite Wastewater System

County: **Saluda**

Name: **AMERICAN LAND HOLDINGS LLC**

Address:

Program Code: **362**

Type Facility: **HOUSE**

59 MIDDLETON DR

TM#:

LUGOFF, SC 29078

Subdivision **PALMETTO POINTE**

Site: **LOT 94**

Water Supply: **PUBLIC**

Block:

Lot: **94**

, SC



LAND RESOURCE MANAGEMENT

Land Evaluation by Land Experts

SYSTEM SPECIFICATIONS

Est. Daily Flow(in GPD) 360 LTAR 1.25 Tank Size(Gallons) 1000 Pump Chamber Size(Gallons) 1000 Min. Pump Capacity gpm @ feet of head ZSS(in inches)

Water table encountered? Yes No

Trenches

Total Number 6 Length(in feet) 500' Width(in inches) 48" Max. Depth(in inches) 12" aggregate mtl. rock Aggregate Depth 9 Alternative product

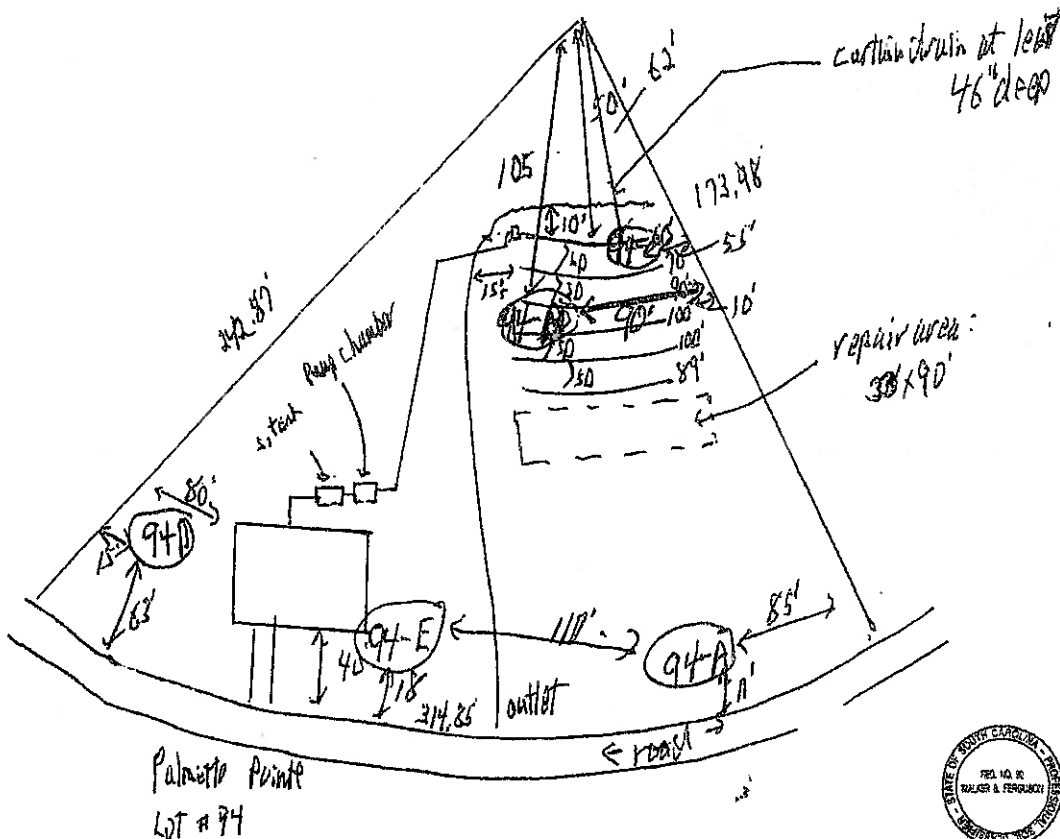

Walter S. Pennington