



**PERMIT TO CONSTRUCT**  
**Onsite Wastewater System**

File Nbr **2019090037**  
County: Saluda

Name: AMERICAN LAND HOLDINGS LLC

Type Facility: HOUSE

Subdivision: PALMETTO POINTE

Block: Lot: 93

Address: 59 MIDDLETON DR  
LUGOFF, SC 29078

Site: LOT 93  
, SC

Program Code: 360

System Code: 815

TM#:

Water Supply: PUBLIC

**PERMIT TO CONSTRUCT SYSTEM SPECIFICATIONS**

Daily Flow (gpd): 360

LTAR: .25

**Tank Sizes (gal):** Septic Tank: 1000

Pump Chamber: 1000

Grease Trap:

**Trenches:** Length (ft): 360

Width (in): 36

Max. Depth (in): 28

Agg. Depth (in):

Min Pump Capacity: 10

gpm at 20

ft. of Head

**SPECIAL INSTRUCTIONS/CONDITIONS**

THIS PERMIT IS SITE SPECIFIC. ANY CHANGES TO THE SYSTEM MUST BE APPROVED BY DHEC. ALTERNATIVE TRENCH PRODUCTS APPROVED UNDER STATE RULES AND REGULATIONS MAY BE SUBSTITUTED. ANY UNAPPROVED CHANGES WILL VOID THIS PERMIT

See Attached Page...

**PERMIT TO CONSTRUCT SYSTEM DIAGRAM**

(NTS)

*System design by  
Land Resource Management Soil  
Classifier Walker Ferguson  
828-231-1663  
see Attached supplemental  
diagram*

Issued/Revised By:

Date:

*11/15/19*

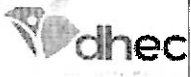

# APPLICATION SUPPLEMENTAL FORM

## Onsite Wastewater System

File Nbr: **2019090037**

County: **Saluda**

Name: **AMERICAN LAND HOLDINGS LLC**

Address:

**59 MIDDLETON DR  
LUGOFF, SC 29078**

Program Code: **360**

Type Facility: **HOUSE**

TM#:

Subdivision **PALMETTO POINTE**

Site: **LOT 93**

Water Supply: **PUBLIC**

Block: Lot: **93**

, **SC**



## LAND RESOURCE MANAGEMENT

Land Evaluation by Land Experts

### SYSTEM SPECIFICATIONS

Est. Daily Flow(in GPD) 360 LTAR, 25 Tank Size(Gallons) 1200 Pump Chamber Size(Gallons) 1200 Min. Pump Capacity \_\_\_ gpm@ \_\_\_ feet of head ZSS(in inches) \_\_\_  
Water table encountered? Yes \_\_\_ No \_\_\_

### Trenches

Total Number 6 Length(in feet) 360 Width(in inches) 36 Max. Depth(in inches) 28 aggregate mtl. \_\_\_ Aggregate Depth \_\_\_ Alternative product Steel, Quick Infiltrator - 12"

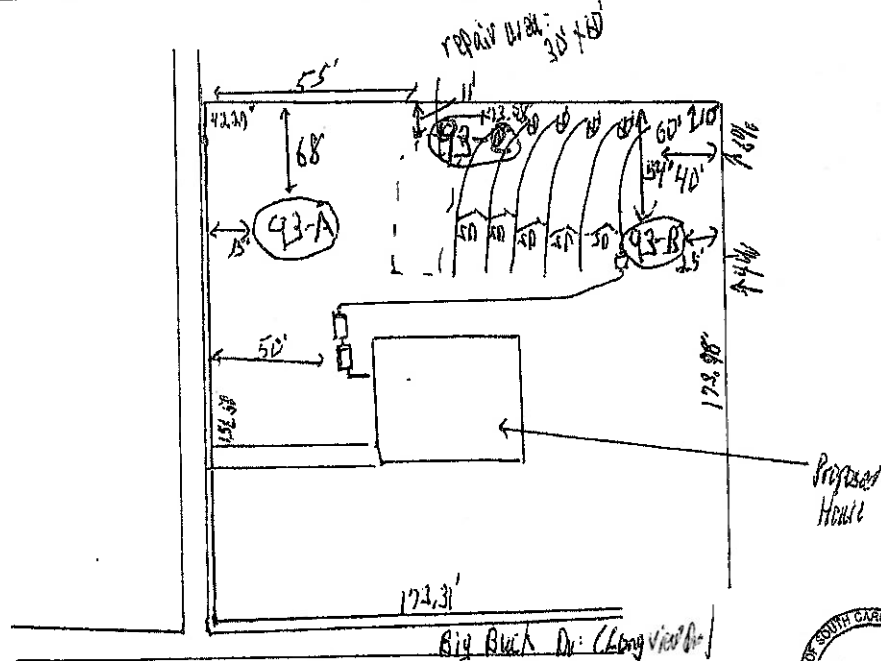

Palmetto Pointe  
Lot 93

