



PERMIT TO CONSTRUCT
Onsite Wastewater System

File Nbr: **2019110015**
County: Saluda

Name: AMERICAN LAND HOLDINGS LLC

Type Facility: HOUSE

Subdivision: PALMETTO POINTE

Block: Lot: 89

Address: 59 MIDDLETON DR
LUGOFF, SC 29078

Site: CLOUDS CREEK CIR LOT 89
SALUDA, SC

Program Code: 360

System Code: 815

TM#:

Water Supply: PUBLIC

PERMIT TO CONSTRUCT SYSTEM SPECIFICATIONS

Daily Flow (gpd): 360

LTAR: .25

Tank Sizes (gal): Septic Tank: 1000 Pump Chamber: 1000 Grease Trap:
Trenches: Length (ft): 360 Width (in): 36 Max. Depth (in): 27 Agg. Depth (in):
Min Pump Capacity: 10 gpm at 20 ft. of Head

SPECIAL INSTRUCTIONS/CONDITIONS

THIS PERMIT IS SITE SPECIFIC. ANY CHANGES TO THE SYSTEM MUST BE APPROVED BY DHEC. ALTERNATIVE TRENCH PRODUCTS APPROVED UNDER STATE RULES AND REGULATIONS MAY BE SUBSTITUTED. ANY UNAPPROVED CHANGES WILL VOID THIS PERMIT

See Attached Page...

PERMIT TO CONSTRUCT SYSTEM DIAGRAM

(NTS)

*System design by
Land Resource Management soil
Classifier Walker Ferguson
828-231-1663
see Attached supplemental
diagram*

Issued/Revised By: *[Signature]*

Date: 12/10/19

DHEC 1781 (01/2014)

This Permit is Appealable Under the Administrative Procedures Act.
There may be an Additional Fee for Changes in this Permit that Require a Site Reevaluation.



APPLICATION SUPPLEMENTAL FORM

Onsite Wastewater System

File Nbr: **2019110015**

County: **Saluda**

Name: **AMERICAN LAND HOLDINGS LLC**

Address:

**59 MIDDLETON DR
LUGOFF, SC 29078**

Program Code: **360**

Type Facility: **HOUSE**

Subdivision **PALMETTO POINTE**

Site: **CLOUDS CREEK CIR LOT 89
SALUDA, SC**

TM#:

Water Supply: **PUBLIC**

Block: Lot: **89**



LAND RESOURCE MANAGEMENT

Land Evaluation by Land Experts

SYSTEM SPECIFICATIONS

Est. Daily Flow(in GPD) 360 LTAR 15 Tank Size(Gallons) 1000 Pump Chamber Size(Gallons) 1000 Min. Pump Capacity ___ gpm@ ___ feet of head ZSS(in inches) ___

Water table encountered? Yes ___ No ___

Trenches

Total Number 5 Length(in feet) 367 Width(in inches) 36 Max. Depth(in inches) 37 aggregate mtl. ___ Aggregate Depth ___ Alternative product SD, Quik 4 Infiltrator - (1d)

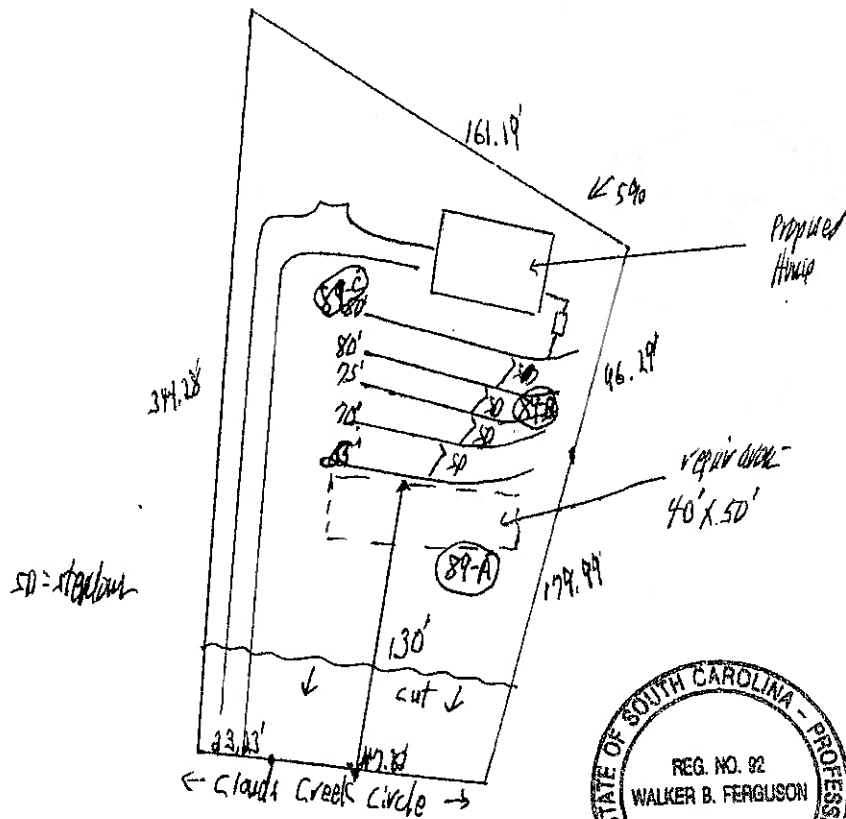

Palmetto Pointe
Lot # 89

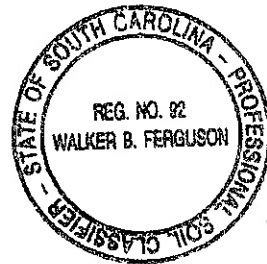

Walker B. Ferguson