



PERMIT TO CONSTRUCT  
Onsite Wastewater System

File Nbr: 2019090027  
County: Saluda

Name: AMERICAN LAND HOLDINGS LLC

Type Facility: HOUSE

Subdivision: PALMETTO POINTE

Block: Lot: 45

Address: 59 MIDDLETON DR  
LUGOFF, SC 29078

Site: LOT 45  
SC

Program Code: 360

System Code: 815

TM#:

Water Supply: PUBLIC

PERMIT TO CONSTRUCT SYSTEM SPECIFICATIONS

Daily Flow (gpd): 360

LTAR: .30

Tank Sizes (gal): Septic Tank: 1000 Pump Chamber: 1000

Trenches: Length (ft): 300 Width (in): 36 Max. Depth (in): 27

Min Pump Capacity: 10 gpm at 10

Grease Trap:

Agg. Depth (in):

ft. of Head

SPECIAL INSTRUCTIONS/CONDITIONS

THIS PERMIT IS SITE SPECIFIC. ANY CHANGES TO THE SYSTEM MUST BE APPROVED BY DHEC. ALTERNATIVE TRENCH PRODUCTS APPROVED UNDER STATE RULES AND REGULATIONS MAY BE SUBSTITUTED. ANY UNAPPROVED CHANGES WILL VOID THIS PERMIT.

See Attached Page...

PERMIT TO CONSTRUCT SYSTEM DIAGRAM

(NTS)

System design by  
Land Resource Management soil  
Classifier Walker Ferguson  
828-231-1663  
see Attached supplemental  
diagram

Issued/Revised By:

Date:

11/13/19

DHEC 1781 (01/2014)

This Permit is Appealable Under the Administrative Procedures Act.  
There may be an Additional Fee for Changes in this Permit that Require a Site Reevaluation.



# APPLICATION SUPPLEMENTAL FORM

File Nbr: **2019090027**

## Onsite Wastewater System

County: **Saluda**

Name: **AMERICAN LAND HOLDINGS LLC**

Address:

Program Code: **360**

Type Facility: **HOUSE**

**59 MIDDLETON DR  
LUGOFF, SC 29078**

TM#:

Subdivision **PALMETTO POINTE**

Site: **LOT 45  
SC**

Water Supply: **PUBLIC**

Block: Lot: **45**



# LAND RESOURCE MANAGEMENT

Land Evaluation by Land Experts

### SYSTEM SPECIFICATIONS

Est. Daily Flow(in GPD) 360 LTAR 3 S.Tank Size(Gallons) 1000 Pump Chamber Size(Gallons) 1000 Min. Pump Capacity      gpm@      feet of head ZSS(in inches)      Water table encountered? Yes      No     

### Trenches

Total Number 4 Length(in feet) 300' Width(in inches) 36" Max. Depth(in inches) 27" aggregate mtl.      Aggregate Depth      Alternative product 5 ft. Quikrete Infiltrator - 12"

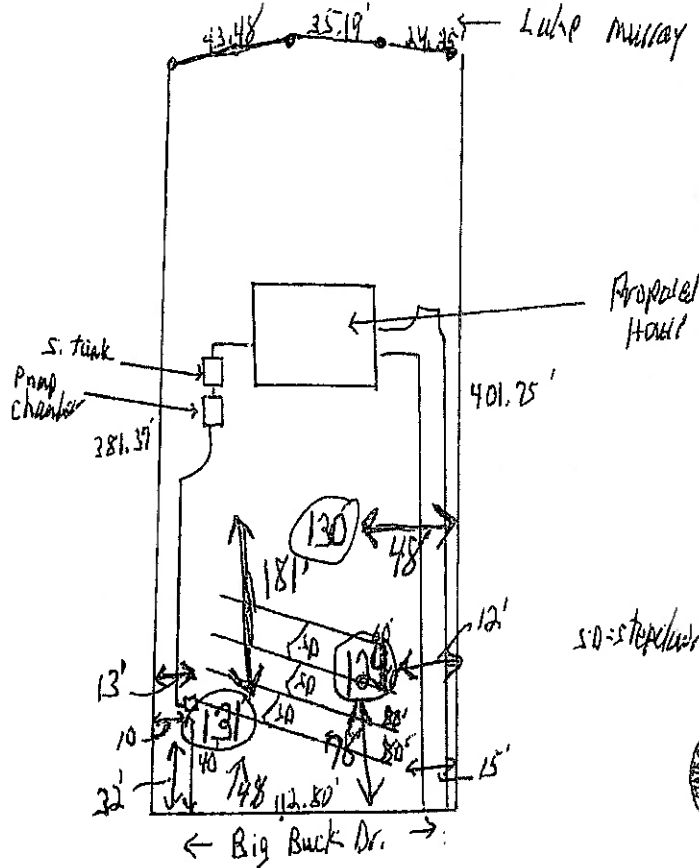

*Walker & Ferguson*